

AiVA

Instructions

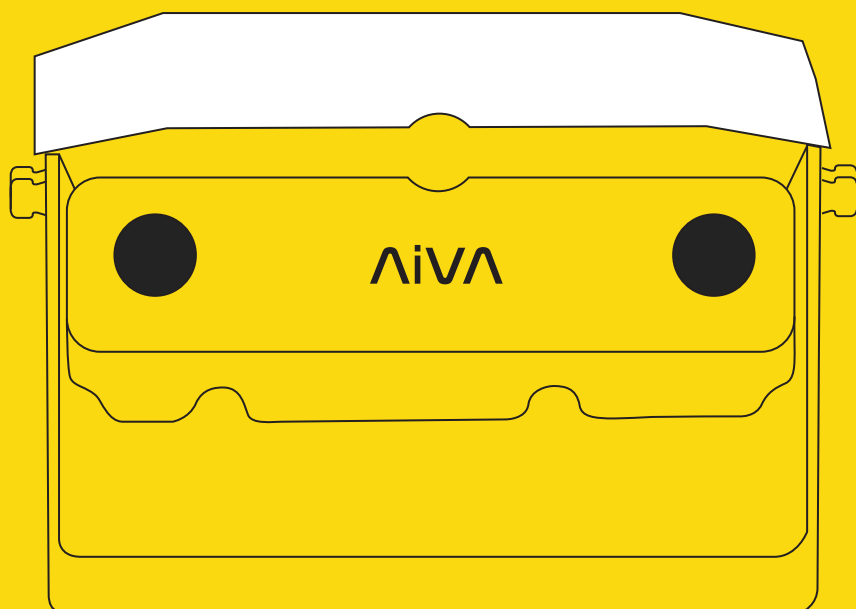

What's in the box

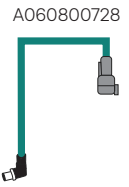
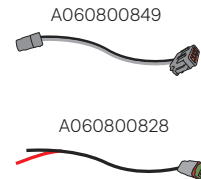
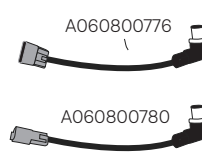
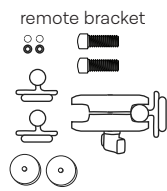
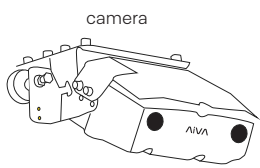

Installation guide

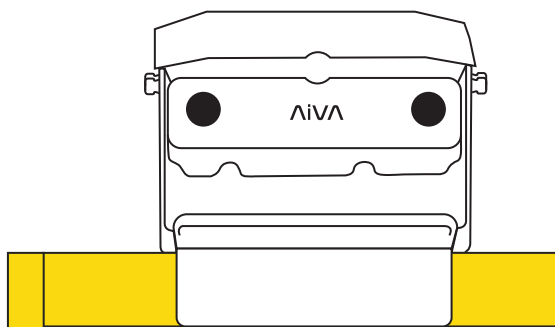

1 ↑
Mount the camera with magnets in desired position

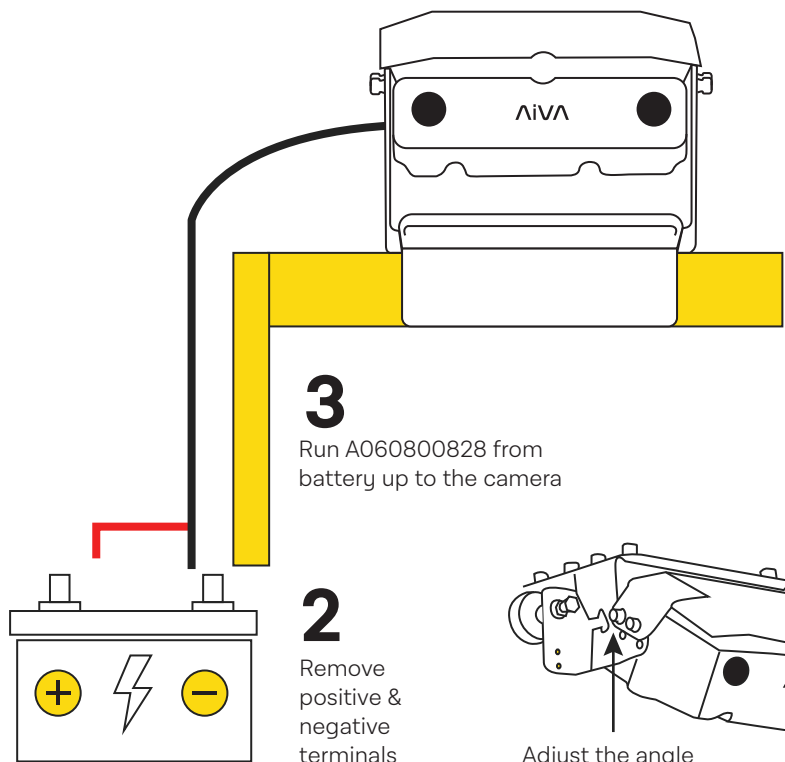

3
Run A060800828 from battery up to the camera

2
Remove positive & negative terminals

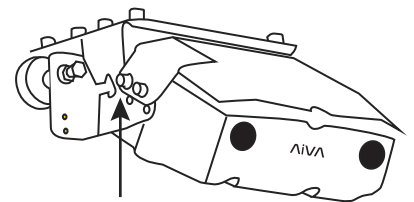

Adjust the angle with these screws.

Remote bracket

1 Screw ball mount onto the back of the remote

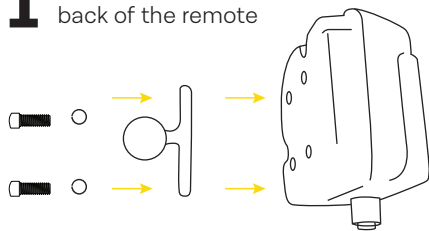

2 Screw the magnets into the back of the ball mount

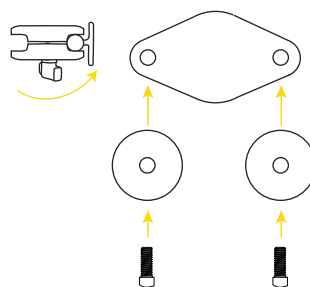

3 Mount the remote with magnet

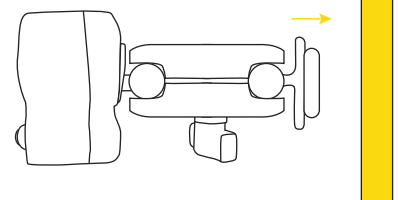

Connecting the cables

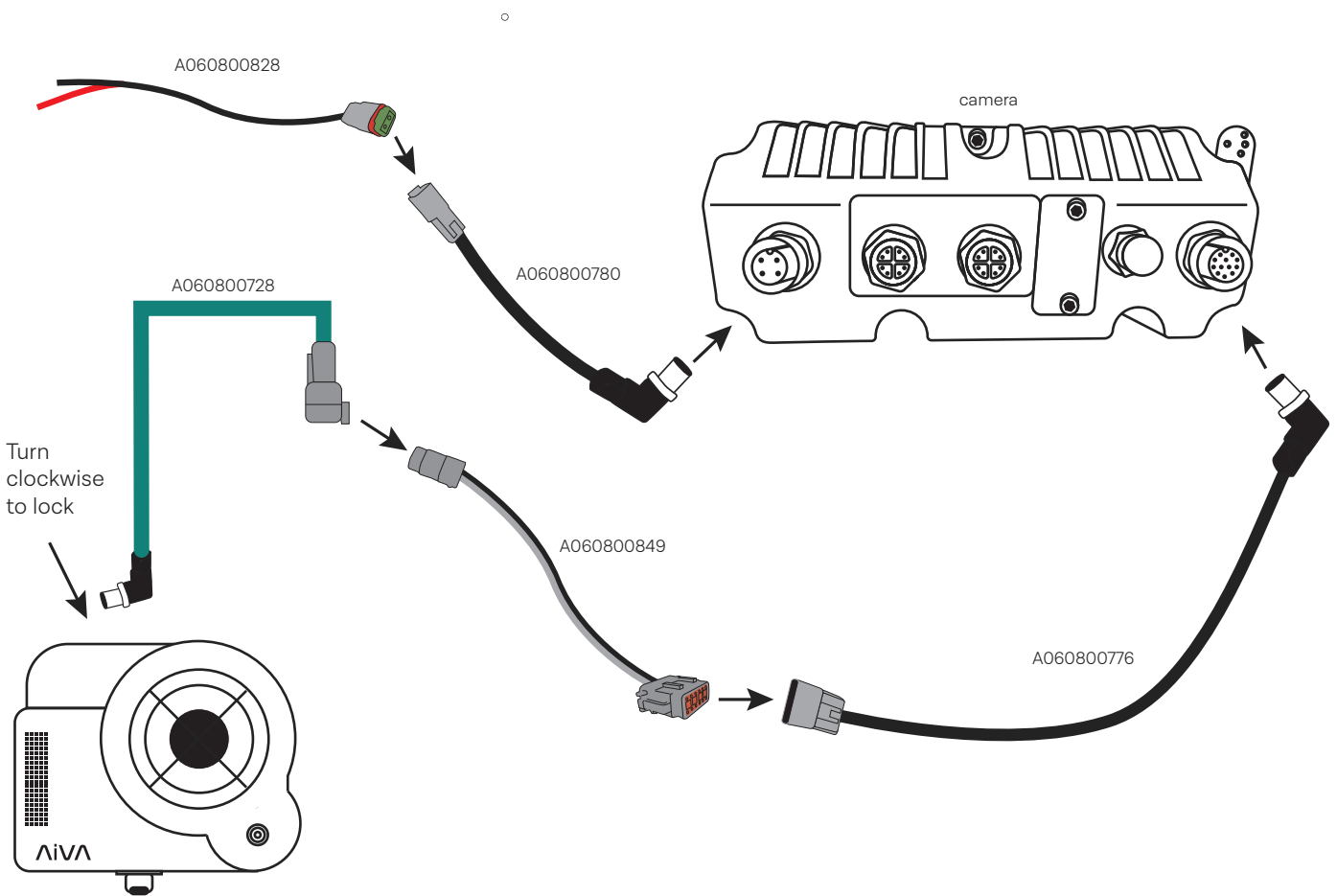

Run A06080072 from remote up to camera, secure with cable ties

Testing



Handbrake up*

*Only applicable to equipment with handbrake.



Wait 30 seconds



Turn ignition to 1st



Scan for more information about testing and activation.

Please see the instructional video for timer relay installation.

Download the app to activate



aiva.speedshield.com

